

WINSLOW

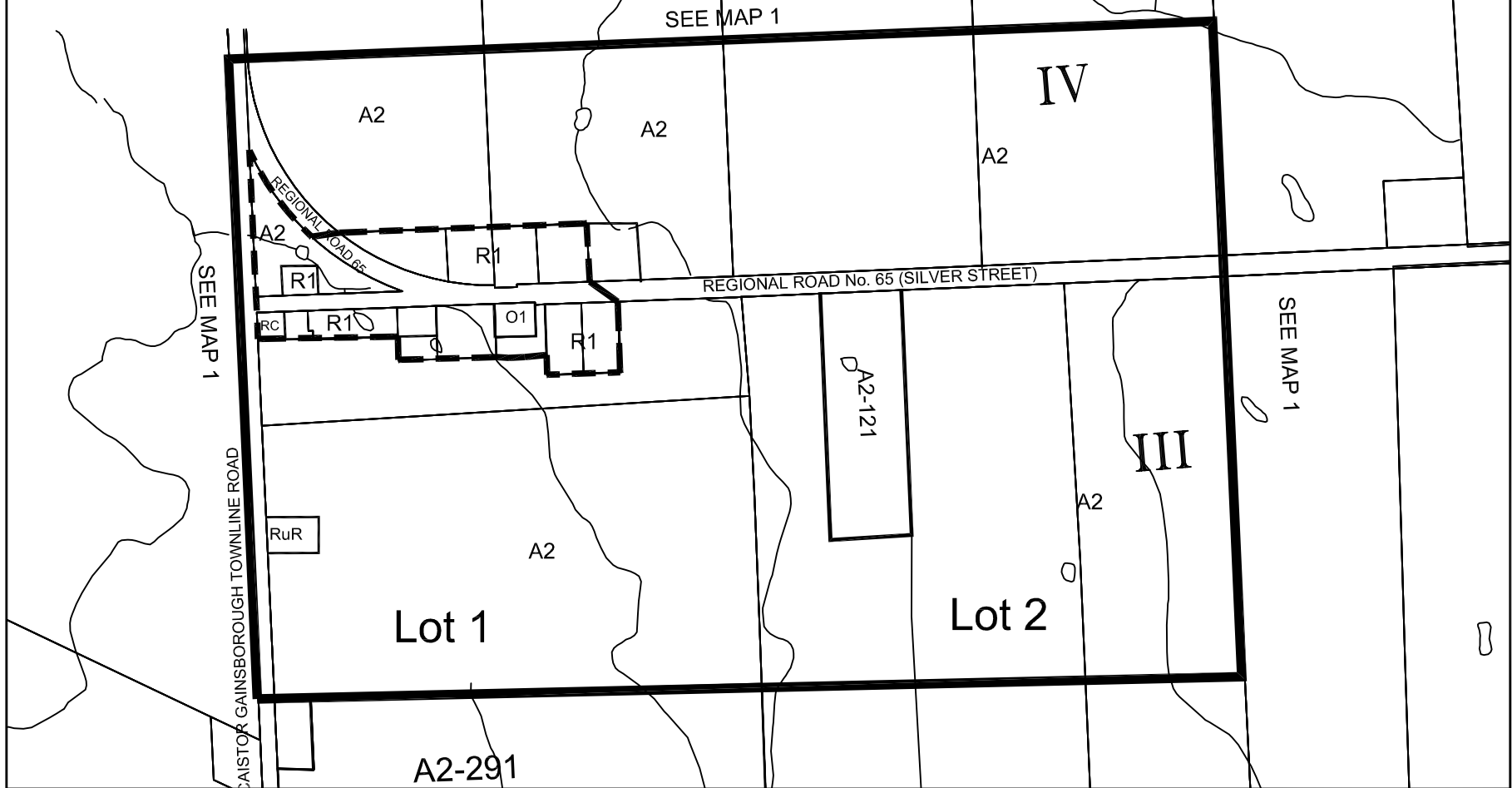

ATTERCLIFFE

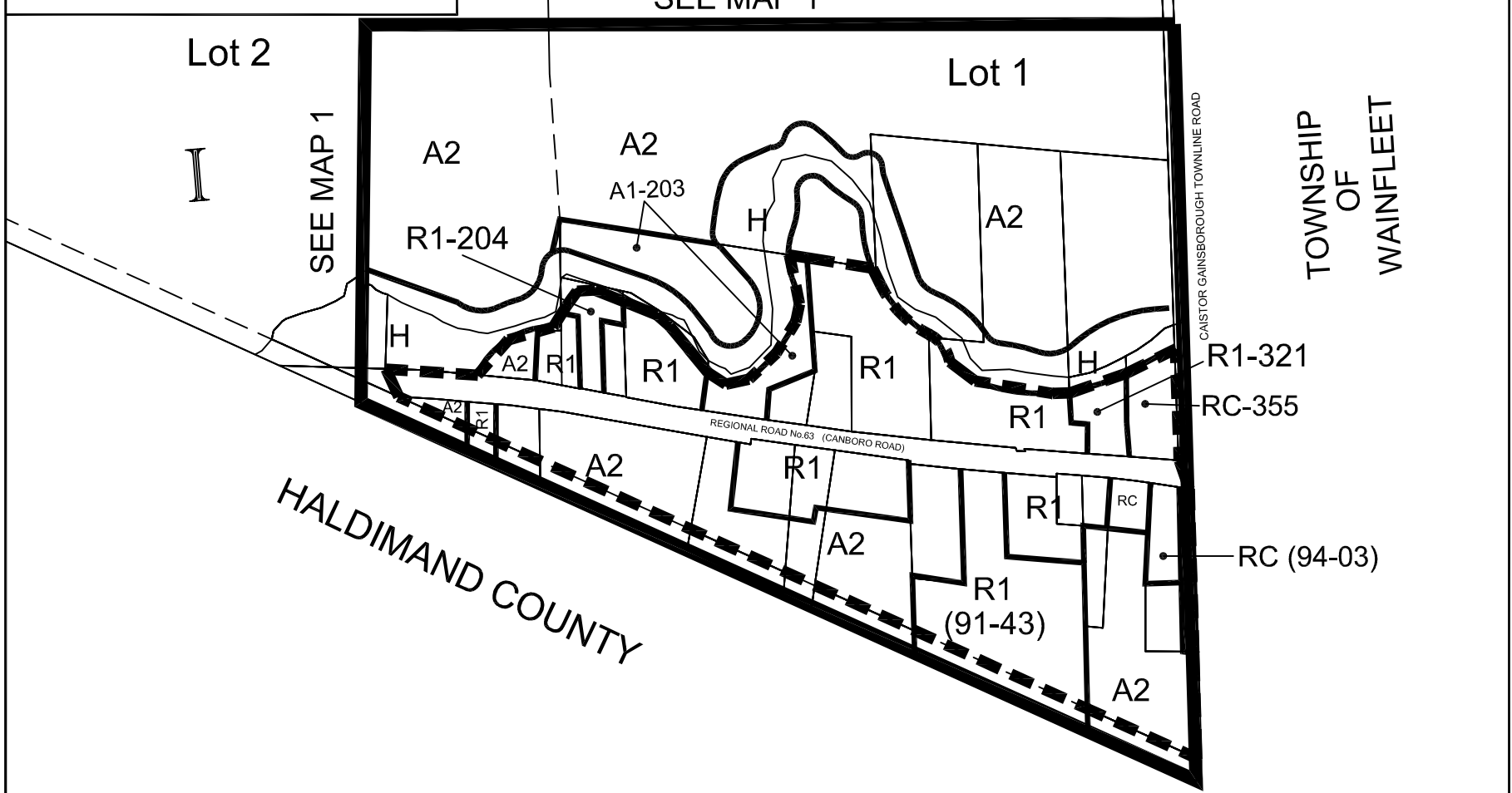

TOWNSHIP OF WEST LINCOLN

THIS IS MAP 6
TO SCHEDULE "A", BY-LAW No. 79-14
PASSED THIS 5th DAY OF MARCH 1979.

'C.O. HODGKINS' MAYOR
'J.G. KILLINS' CLERK

OFFICE CONSOLIDATION

This is an Office Consolidation of Zoning By-law No. 79-14 of the Township of West Lincoln as passed by Council on March 5, 1979.

For accurate reference, recourse should be made to the original Zoning By-law No. 79-14 and amending By-laws.

Consolidated Version November 2009

ZONES

RESTRICTED AGRICULTURAL
AGRICULTURAL
RESIDENTIAL
RESIDENTIAL
RESIDENTIAL MULTIPLE
RESIDENTIAL MULTIPLE
RURAL RESIDENTIAL
DEVELOPMENT
TRAILER CAMP
SCHEDULE BOUNDARY

SYMBOLS

A1
A2
R1
R2
RM1
RM2
RuR
D
T2

ZONES

LOCAL COMMERCIAL
GENERAL COMMERCIAL
HIGHWAY COMMERCIAL
RURAL COMMERCIAL
INDUSTRIAL
PUBLIC INDUSTRIAL
INSTITUTIONAL
PUBLIC
OPEN SPACE
HAZARD

SYMBOLS

C1
C2
C3
RC
M1
M2
I
P
O1
H

RURAL CLUSTER BOUNDARY (By-Law No. 2008-29)



FOR INFORMATION PURPOSES ONLY.
MAY NOT BE TO SCALE.